

# Technical data sheet



## Product features

### Cooling cabinet GN 700 l stainless steel

<b>Model</b>	<b>SAP Code</b>	00013348
--------------	-----------------	----------



- GN / EN size in device: GN 2/1
- Chamber volume [l]: 670
- Minimum device temperature [°C]: 2
- Maximum device temperature [°C]: 8
- Insulation thickness [mm]: 60
- Control type: Digital
- Interior lighting: Yes
- Door lock: Yes
- Opening of device: Two-sided
- Automatic defrost: Yes
- HACCP: No
- Annual energy consumption [kWh]: 883

<b>SAP Code</b>	00013348	<b>Gross Volume [m3]</b>	1.370
<b>Net Width [mm]</b>	740	<b>Net Volume [m3]</b>	1.235
<b>Net Depth [mm]</b>	830	<b>GN / EN size in device</b>	GN 2/1
<b>Net Height [mm]</b>	2010	<b>Minimum device temperature [°C]</b>	2
<b>Net Weight [kg]</b>	113.00	<b>Maximum device temperature [°C]</b>	8
<b>Power electric [kW]</b>	0.230	<b>Refrigerant</b>	R290
<b>Loading</b>	230 V / 1N - 50 Hz	<b>Refrigerant weight [g]</b>	100.00
<b>Energy class</b>	D	<b>Climate class</b>	4
<b>Chamber volume [l]</b>	670		

# Technical data sheet



Technical drawing

Cooling cabinet GN 700 l stainless steel

Model

SAP Code

00013348

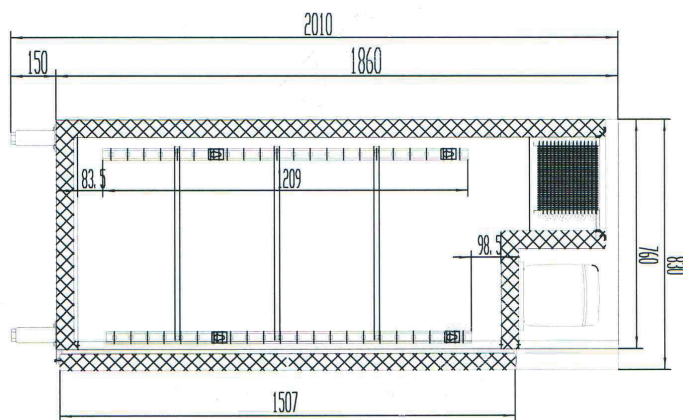
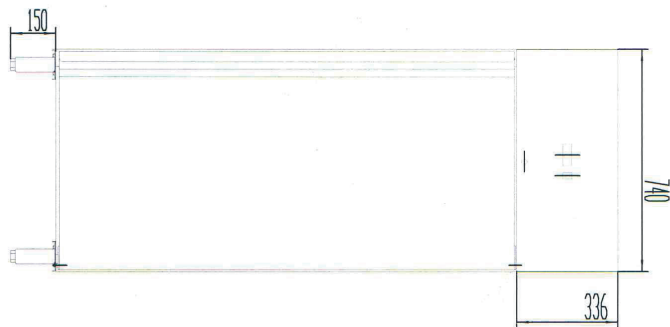
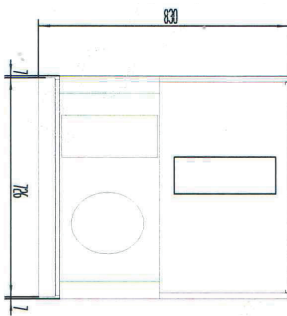

# Technical data sheet



## Technical parameters

### Cooling cabinet GN 700 l stainless steel

**Model**

**SAP Code**

00013348

**1. SAP Code:**

00013348

**2. Net Width [mm]:**

740

**3. Net Depth [mm]:**

830

**4. Net Height [mm]:**

2010

**5. Net Weight [kg]:**

113.00

**6. Gross Width [mm]:**

765

**7. Gross depth [mm]:**

865

**8. Gross Height [mm]:**

2070

**9. Gross Weight [kg]:**

123.00

**10. Device type:**

Electric unit

**11. Power electric [kW]:**

0.230

**12. Loading:**

230 V / 1N - 50 Hz

**13. Energy class:**

D

**14. Refrigerant:**

R290

**15. Cooling type:**

Static with fan

**16. Material:**

Stainless steel

**17. Exterior color of the device:**

Stainless steel

**18. Min ambient temperature [°C]:**

10

**19. Max ambient temperature [°C]:**

43

**20. Additional information:**

inside width 624 mm

**21. Device properties 2:**

Cooling

**22. GN / EN size in device:**

GN 2/1

**23. Chamber volume [l]:**

670

**24. Gross Volume [m3]:**

1.370

**25. Net Volume [m3]:**

1.235

**26. Worktop material:**

SS201

**27. Adjustable feet:**

Yes

**28. Pizza design:**

No

# Technical data sheet



## Technical parameters

### Cooling cabinet GN 700 l stainless steel

Model

SAP Code

00013348

**29. Insulation thickness [mm]:**

60

**30. Opening of device:**

Two-sided

**31. Number of doors:**

1

**32. Unit:**

Yes

**33. Control type:**

Digital

**34. Door lock:**

Yes

**35. Interior lighting:**

Yes

**36. HACCP:**

No

**37. Annual energy consumption [kWh]:**

883

**38. Minimum device temperature [°C]:**

2

**39. Maximum device temperature [°C]:**

8

**40. Automatic defrost:**

Yes

**41. Thaving cycle:**

Yes

**42. Humidification:**

No

**43. Refrigerant weight [g]:**

100.00

**44. Number of grids:**

3

**45. Climate class:**

4

**46. Cross-section of conductors CU [mm<sup>2</sup>]:**

0,5

- Výkon (kW): 2,4-3,3 (230 V)